

Whole-House Water Filtration System

WH Clean 2SCS

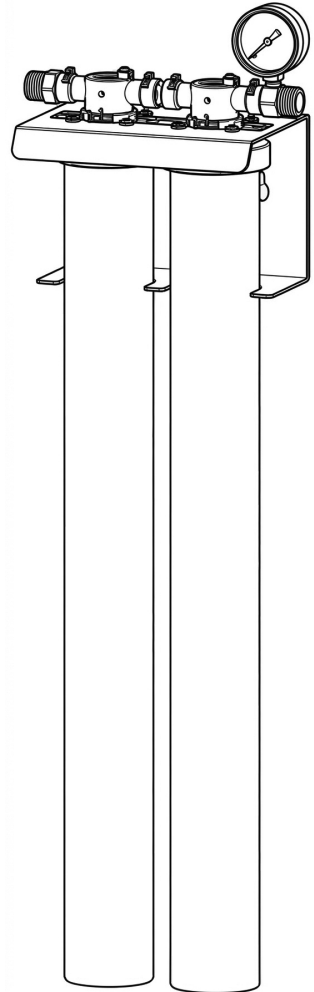

Use and Care

Table of Contents

- **Product Overview** 4
 - About Product 4
 - Specifications 4
 - Components 5
 - Tools Needed 6
 - Parts Not Included 6

- **Installation** 7
 - Pre-Installation Notes 7
 - Pre-Installation 8
 - Installation Overview 8
 - Installation Instructions 9

- **Maintenance Instructions** 15
- **Filter Change Instructions** 16
- **Check before Reporting Malfunction** 19
- **Frequently Asked Questions** 20
- **Warranty** 21
- **Warranty Registration Form** 23

Product Overview

Cleaner water for your whole home.

About Product

Tap water often contains chlorine and sediment that can affect the taste, smell, and overall quality of the water used throughout your home.

A whole-house filter, installed at the Point of Entry (POE), ensures cleaner and more reliable water for every tap in your household.

Our Whole-House Water Filtration System is designed to maintain strong flow rates while effectively reducing impurities, making it suitable for both residential and light commercial applications.

Specifications

Flow Rate	5 – 13 GPM
Peak Flow Rate	13 GPM
Minimum Working Pressure	29 psi
Maximum Working Pressure	80 psi
Operating Temperature	40 - 100 °F (4 - 37 °C)
pH Range	6.0 – 9.0

Components

Part	Description	Qty
Bracket with heads	Metal bracket with heads and stainless-steel PT ¼ inlet/outlet	1
Housings	Stainless-steel housing with cover	2
Cartridges	WH-SD filter : Sediment filter x 1 WH-CBSI filter : Carbon block filter with scale inhibitor x 1 * Filters are included in the housing.	2
Screws	Installation screws and plastic anchors	2

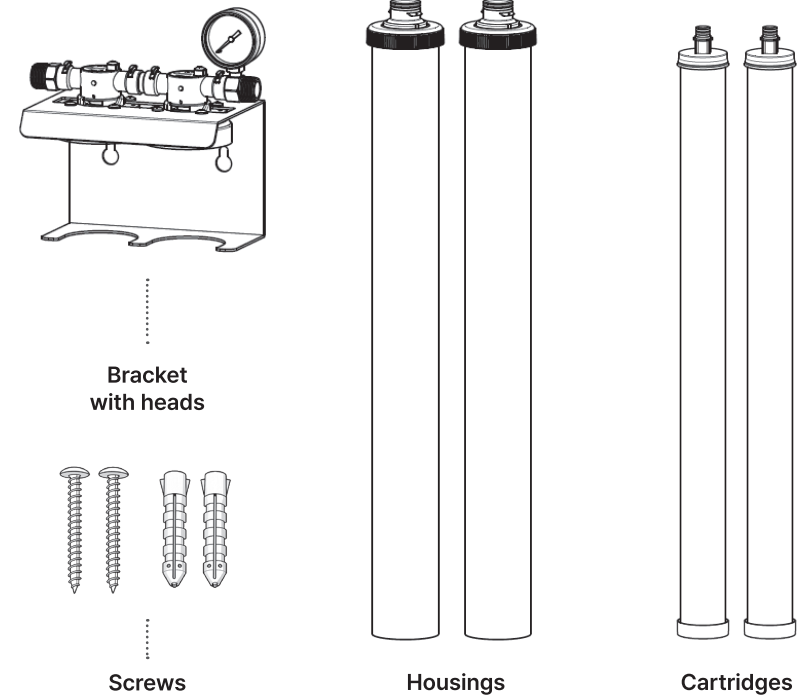

▪ Tool Needed

Safety Glasses	Pipe Cutter
Towels	Torch
Phillips Screwdriver	Adjustable Wrench & Medium Crescent Wrench
Deburring Tools	Plumber's Tape
Masonry Drill Bit [10 mm] (as needed)	Hammer Drill (as needed)

▪ Parts Not Included

- (4x) Shutoff valves
- (2x) 3/4" female PT threaded adapters
- (x) Hex nipples or pipe nipples
- (x) Pipe hangers
- (1x) Pipe union pressure regulators (as needed)
- (1x) Ground jumper cable (as needed)

Installation

▪ Pre-Installation Notes

- This installation guide provides a step-by-step, start-to-finish procedure for installing your WH Clean 2SCS whole-house water filter. All steps provided herein are for typical installations only. Your specific application may vary.
- Do not use this system with water that is microbiologically unsafe or of unknown quality without adequate disinfection.
- The filter system must be installed in a sheltered location. Avoid exposure to freezing or extreme temperatures, as well as direct sunlight. Damage resulting from such exposure is not covered under the warranty.
- Verify the flow direction markings on the unit to ensure proper orientation before connecting the pipes.
- Hard copper pipes are generally available in two types. We recommend using the thicker 'Type L' copper pipe rather than the thinner 'Type M' for this installation.
- Ensure all installations comply with local plumbing and building codes.
- Apply plumber's tape to all threaded fittings to ensure a watertight seal.

■ Pre-Installation

- Turn off the main water supply to the house before beginning the installation.
- Turn off power to your water heater before installation.
- Open several faucets throughout the house to drain the lines and relieve water pressure.
- Before beginning, lay out all the necessary fittings and tools required for your specific installation configuration.

■ Installation Overview

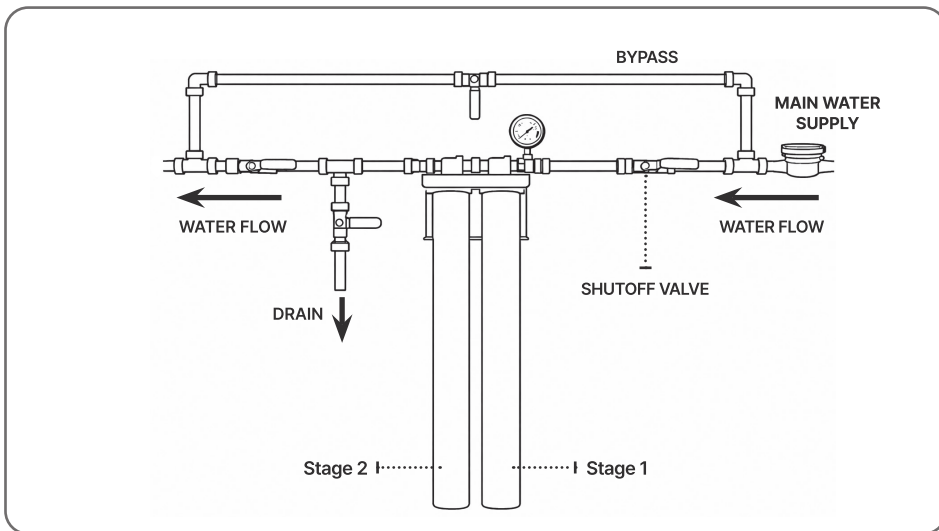

Stage 2	Stage 1
Carbon block filter with scale inhibitor (WH-CBSI filter)	Sediment filter (WH-SD filter)

■ Installation Instructions

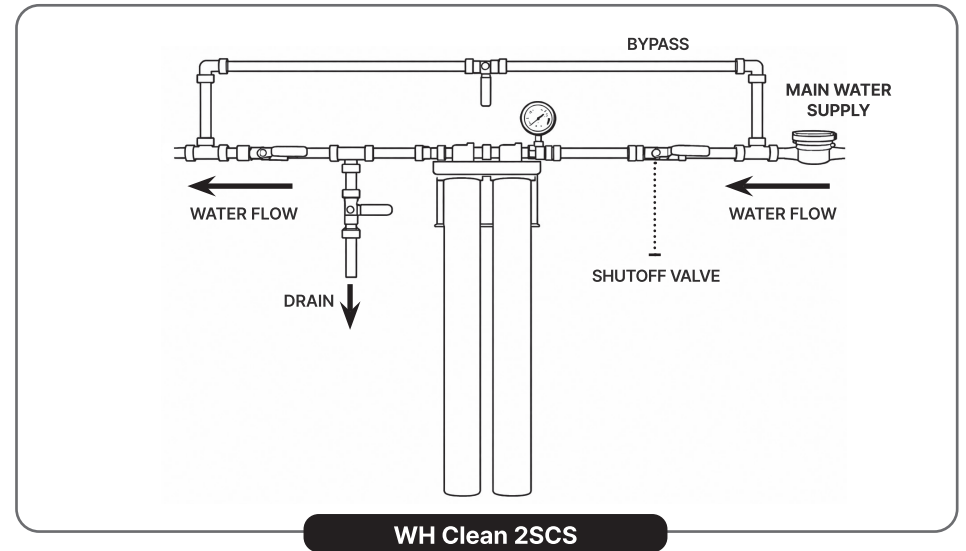

- The filter should be placed on the main water supply line close to where it enters the house. This can be at any point past the main shutoff valve for the whole house but before pipes branch off into multiple directions. However, you may choose to locate the filter after the line branches to the inside and outside plumbing depending on your filtration intent. Your filter should be in a dry, level area and protected from freezing temperatures and direct sunlight.
- Fit pipe hanger (not included) on both the water INLET and OUTLET side for additional support.



Notice

WH Clean 2SCS comes with a 3/4" PT male inlet/outlet, which may require additional fittings to adapt to your plumbing. A shutoff valve is recommended.

Step 1 Measure the System and Cut the Pipe

- Determine the location and water-flow direction of the system.

! Notice

If the pre-installed head connection flow direction is opposite to your piping layout, loosen the screws on the bracket to reverse the orientation.

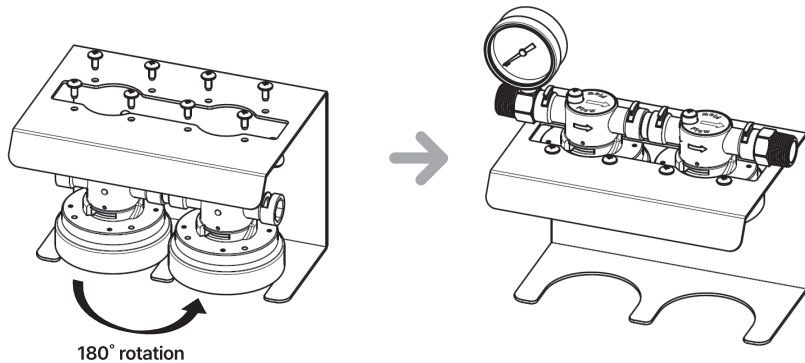
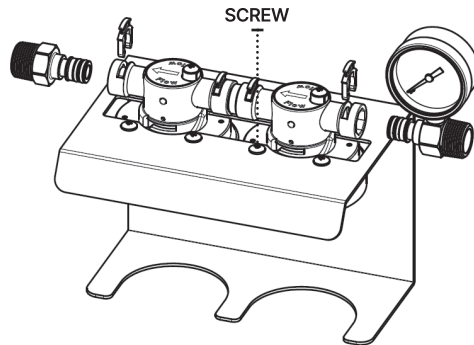

- Measure, cut, and remove the section of the water line where the system will be installed. When calculating the length of the pipe to be removed, be sure to account for the total width of the filter assembly, shut-off valves, unions, nipples, and bypass valves (if applicable).
- Allow the cut pipe to drain completely. Smooth the newly cut ends using a deburring tool or sandpaper to remove any jagged edges or burrs that could interfere with a proper seal.

Step 2 Mount the Filter Bracket

- Securely mount the whole-house filter bracket and ensure the system is level and stable.

! Notice

For concrete installation, drill holes using a hammer drill and a masonry drill bit [10mm], then insert the included plastic anchors before securing the bracket.

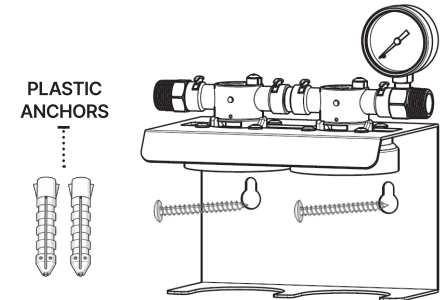

- Attach your plumbing to the INLET and OUTLET with 3/4" female PT threaded adapters (not included). Apply 15–25 wraps of plumber's tape to INLET and OUTLET adapters to prevent leakage.

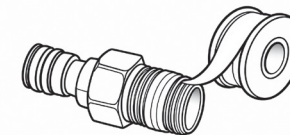

- Insert the INLET and OUTLET adapters (with plumbing attached) into the HEAD and secure them using the PUSH-FIT CONNECTOR.

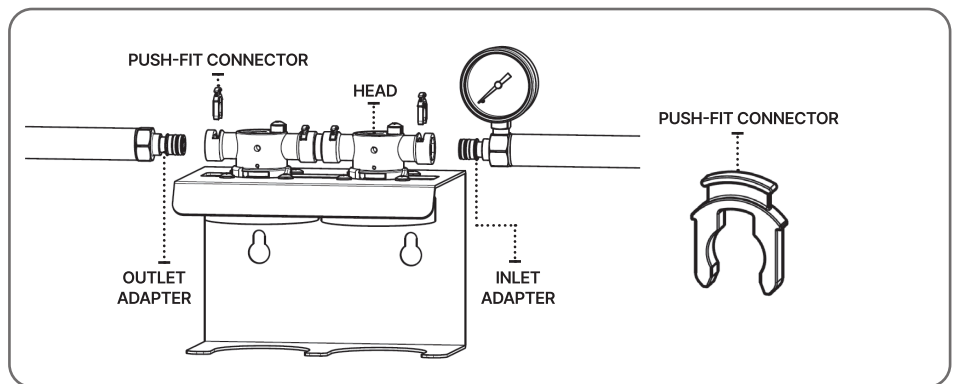

Step 3 Connect Ground Jumper Cable

- Connect the ground jumper cable if you have metal pipes.

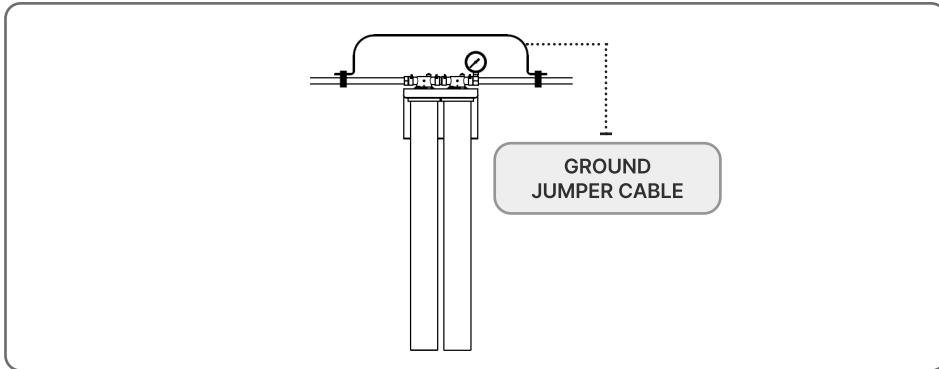

Step 4 Assemble Filter Housing

- Press the filter housing upward into place and turn it counterclockwise by hand to tighten (quarter-turn quick lock).

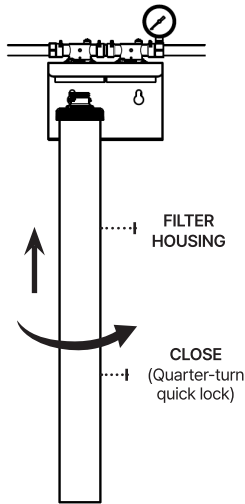

Notice
 Ensure the groove on top of the housing aligns with the groove on the head

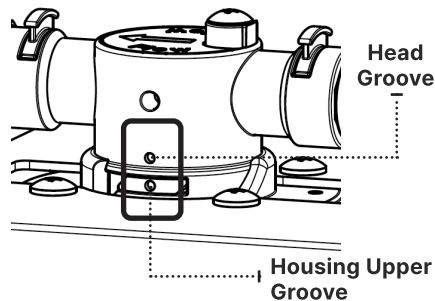

Step 5 Turn on Water and Flush the System

- Close shutoff valves ①, ②, ③, and ④, then turn on the main water supply. Slowly open shutoff valve ③. Open the air vent screws until only water flows out, then retighten them.
- Open shutoff valve ④ and let it stand for about 10 minutes to flush out carbon fines.

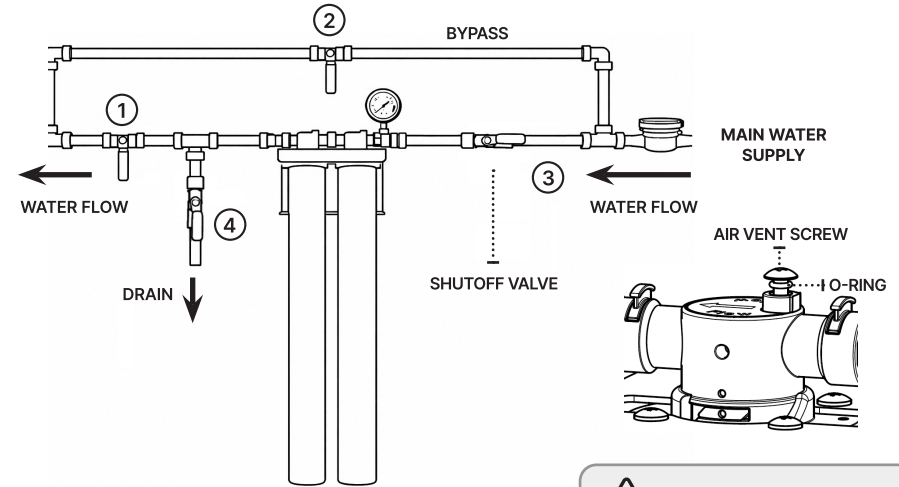

WH Clean 2SCS

Notice
 Take care not to lose O-RING.

Notice
 The water might be blackish in color for the initial flush. This is residual carbon dust and is to be expected. Continue to run water until it runs clear and all air has been purged. Shut the water off, let the unit sit for a while, and then flush again. It is not unusual for the water to appear "cloudy" for a day or so following installation. This cloudiness is actually tiny air bubbles being purged from the filters. This is normal and will clear up in a day or two.

! Notice

After prolonged periods of nonuse (such as during a vacation), it is recommended that the system be flushed thoroughly for at least 10 minutes before using the water.

Step 6 Preparing the System for Use

- Close shutoff valves ①, ② and ④, then open shutoff valve ③. Inspect carefully for any leaks. If a leak occurs, remove the housing to verify that the O-ring is properly seated, then retighten. (Refer to 'Filter Replacement Instructions' on pages 16–19.)
- Slowly open shutoff valve ①. The system is now ready for use.

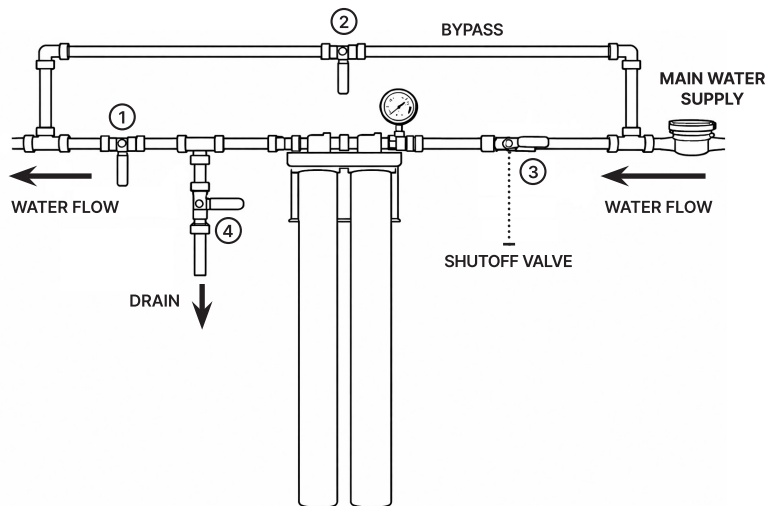

WH Clean 2SCS

! Notice

Raw water may remain in the water lines and the water heater. Through normal use, this water will be replaced with filtered water in about 2 or 3 days.

Maintenance Instructions

Model Name for Replacement Cartridges

WH-SD filter : PP Sediment filter

WH-CBSI filter : Carbon block filter with scale inhibitor

- Your WH Clean 2SCS Whole-House Water System requires scheduled maintenance. It is recommended that the cartridges be replaced every 6-12 months depending on the number of contaminants present in the water supply. If the system has been working properly but the pressure is dropping, it may be time to change the filter cartridge.

Filter Replacement Instructions

part 1 Preparing for Cartridge Replacement

- Turn off the main water supply.
- Close shutoff valves ①, ②, and ③.
- Relieve the pressure in the housing by opening shutoff valve ④ or the air vent screw.

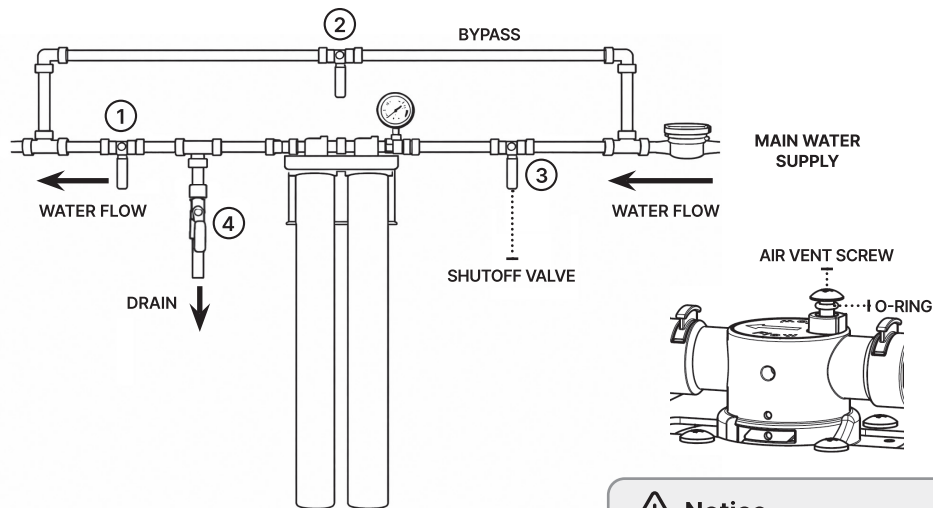

WH Clean 2SCS

⚠ Notice
Take care not to lose O-RING.

part 2 Remove the Old Filter Cartridge

- Rotate the filter housing clockwise and remove it from the head.
- Turn the filter cover counterclockwise to remove it.
- Remove the filter top cover, then take out the used filter cartridge.

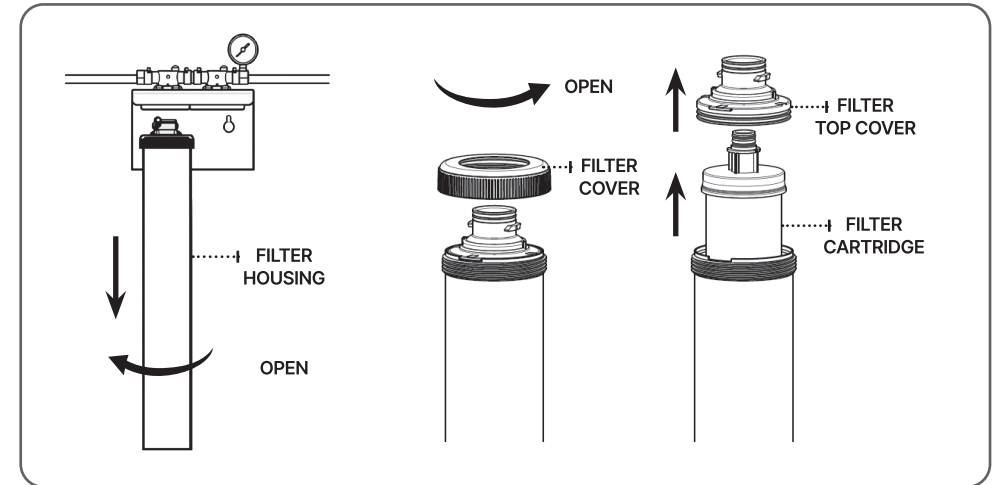

part 3 Clean the Housing

- Wear rubber gloves and thoroughly rinse the filter top cover and filter housing with water to remove any remaining debris.
- Lubricate the O-ring with clean silicone grease if needed. Do not use petroleum jelly.

⚠ CAUTION

If the O-ring appears damaged, stretched, or crimped, it should be replaced.

part 4 Install the New Filter Cartridge

- Remove the new filter packaging and insert the filter cartridge into the filter housing.
- Insert the filter top cover by aligning it with the groove.

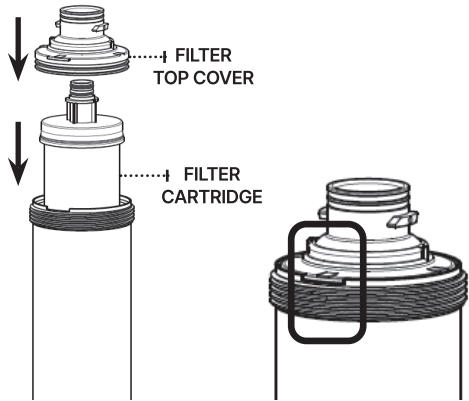

! Notice

Align the protrusions on the filter top cover with the groove on the filter housing, then assemble. Improper assembly may cause product damage or leakage.

- Hand-tighten the filter cover by turning it clockwise until secure. Do not overtighten.
- Press the filter housing upward into place and turn it counterclockwise by hand to tighten (quarter-turn quick lock).

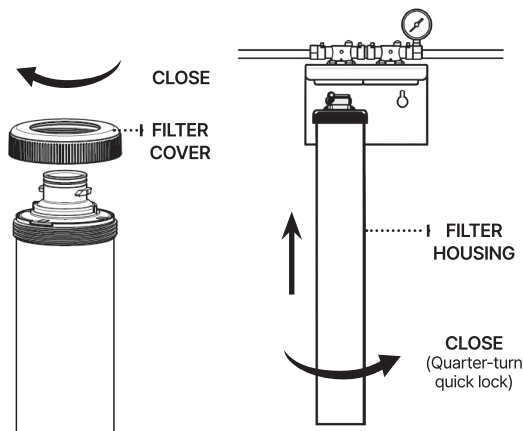

! Notice

Ensure the groove on the top of the housing aligns with the groove on the head.

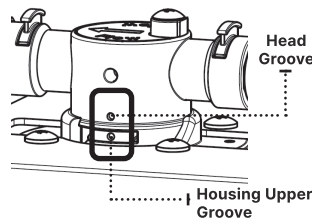

part 5 Turn on Water and Flush the System

- Refer to Step 5 of the Installation Instructions on page 13.

part 6 Preparing the System for Use

- Refer to Step 6 of the Installation Instructions on page 14.

Check before Reporting Malfunction

Problem	Solution
Gradual drop in water pressure over time	Filter cartridges should be replaced every 6–12 months, depending on the level of contaminants in the water supply. If the system is functioning correctly but water pressure decreases, it may indicate that the cartridges need to be replaced.
Low water pressure immediately following installation	1) Ensure that the water is being supplied from the main water supply. 2) Ensure Step 6 on page 14 has been completed as instructed.
Cloudy or greyish water appearance	Water may appear cloudy or grey for the first 1–2 days after installation. This is a normal occurrence as tiny air bubbles are purged from the filters and excess carbon dust is flushed out.
Water leakage at the housing connection	The O-ring may be improperly seated or misaligned. If the leak persists after adjusting the O-ring, please contact Customer Service at www.seondolec.com

Frequently Asked Questions

Q. What contaminants does this system remove, and how does it work?

A. This whole house filtration system features a multi-stage carbon block filter integrated with a sediment and scale inhibitor.

It is designed to provide comprehensive protection:

- **Sediment Filtration:** The outer layer traps physical particles such as dirt, sand, silt, and rust.
- **Carbon Block :** Effectively adsorbs chlorine, tastes, and odors, as well as organic chemicals (VOCs) and pesticides.
- **Scale Inhibitor :** This specialized media does not remove minerals but prevents them from bonding to surfaces. It significantly reduces scale buildup in your pipes and water-using appliances.

Q. With this whole-house system, do I still need to install a water softener if my water is very hard?

A. If your source water has high hardness levels, usually exceeding 700 ppm TDS a water softener is recommended.

This whole-house water filtration system effectively removes sediment, chlorine, and rust; however, it does not soften water. Please note that high hardness causes rapid scale buildup, which can result in clogged filters and a shorter cartridge lifespan.

To ensure this system is right for you, we recommend obtaining a professional water test before purchase to identify your specific water quality issues.



Notice

Water softeners and whole-house water filtration systems generally do not reduce TDS levels. If lower TDS is required for drinking water, an additional Reverse Osmosis (RO) system may be necessary. If you are unsure which product best suits your requirements, please consult with professionals prior to your purchase.

Q. What flow rate should I look for?

A. Flow rate, measured in gallons per minute (GPM), defines the amount of water available for your household needs such as showers, toilets, and appliances. When determining your requirements, check the demand ratings on your water using devices. Most residential flow rate needs range between 5 and 40 GPM depending on home size and family occupancy.

Warranty

■ Limited One-Year Warranty & Disclaimers

Warranty Coverage & Registration

This Limited Warranty extends exclusively to the original purchaser and remains in effect only as long as the system is owned by the original registered owner at its initial installation site.

The warranty period commences on the date of delivery.

This coverage will automatically terminate if the unit is removed or relocated from its original installation location.

Scope of Warranty

For one (1) full calendar year from the date of purchase, the Manufacturer warrants all factory-supplied components against defects in materials, workmanship, or factory preparation.

- **Parts Only:** This is a parts-only warranty. All labor costs are strictly excluded, including but not limited to removal, replacement, installation, adjustment, maintenance, or repair services.
- **Consumables Excluded:** Filter cartridges and O-rings, which require regular replacement through ordinary usage, are not covered.
- **Implied Warranties:** Any implied warranties of merchantability and fitness for a particular purpose shall terminate one (1) year from the date of purchase.

Operating Conditions & Voidance

This warranty is valid only if the system is installed, operated, and maintained in strict compliance with all enclosed instructions.

The warranty shall be rendered void if any of the following conditions are not met:

- **Installation Site:** The system must be installed in a shaded, well-ventilated area away from direct sunlight. Prolonged UV exposure can damage the unit.
- **Water Supply:** Used with a potable water supply only.
- **Pressure & Temp:** Feed water pressure must be between 29–80 psi, and temperature must be between 40–100°F.
- **pH Levels:** Feed water must have a pH level between 6 and 9.
- **Proper Maintenance:** Failure to perform periodic maintenance (e.g., timely filter/media replacement) as described in the literature is considered "neglect" and will invalidate the warranty.

Limitation of Liability

The Manufacturer shall not be responsible for any incidental or consequential damages resulting from the failure of this unit, including but not limited to lost time, inconvenience, damage to personal property, loss of revenue, commercial losses, or travel expenses. In states where the exclusion of incidental or consequential damages is not allowed, you may choose to return the system; however, by choosing to keep the unit, you acknowledge that this exclusion still applies to you.

Performance Disclaimer

While testing was conducted under standard laboratory conditions, actual performance may vary based on local water characteristics. The Manufacturer assumes no liability for determining the specific equipment necessary to meet your requirements.

Customer Support

We are committed to your satisfaction and provide a 1-year manufacturer warranty for all major filtration systems.

If your unit develops a defect, please contact the original retailer or contact Customer Service at www.seondoelec.com. Your satisfaction is our business!

Warranty Registration Form

Name _____ Order# _____

Email _____ Phone _____

Address _____

City _____ State _____ Zip Code _____

Model #/ Serial Number

Purchased at

Date of Purchase _____

SEONDO

www.seondoelec.com